

battery type: Lithium Button Cell (PH-type)
battery size: CR2016
chemical system: Lithium Manganese Dioxide

Conditions

nominal voltage: 3.0 V
open circuit voltage: 3.0...3.4 V (new battery)
 2.9...3.4 V (after 1 year storage at 20°C)

all measurements at 22 ± 2°C ambient

capacity rated: 85 mAh (continuous discharge at 30kΩ load; 24hours/day
 End Voltage (EV): 2.0V)
minimum: 80 mAh (continuous discharge at 30kΩ load; 24hours/day
 EV: 2.0V)

standard discharge time minimum: 155 h (at 5.6kΩ load (for QC measurement)
 EV: 2.0V)

discharge currents standard: 0.1 mA
 max. recommended current under continuous discharge: 4 mA
 max. recommended current under pulse discharge: 12 mA

discharge diagrams:

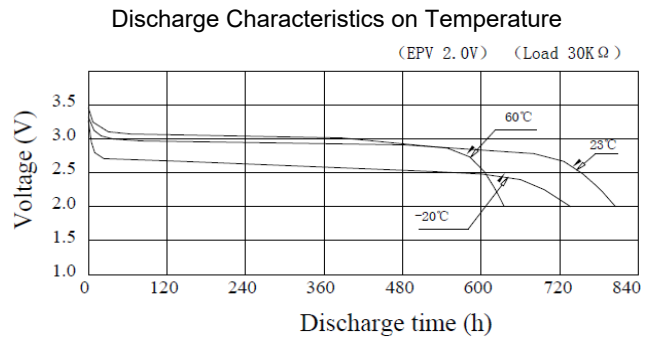
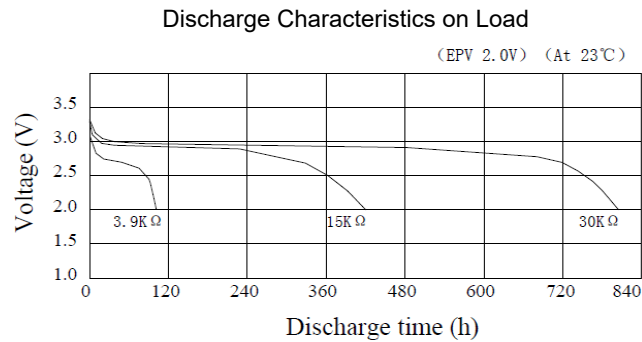

shelf life: 10 years (under proper storage conditions (ta: ≤ 22°C; RH: 60 ± 15%))
self-discharge: ≤ 2 % (per year (at 20°C ambient temperature))

operating temperature range: - 30...65 °C
storage temperature: 0...30 °C (recommended)

mechanical specifications:

outer battery dimensions
 diameter: 20.0mm +0/-0.3mm
 height: 1.6mm +0/-0.2mm

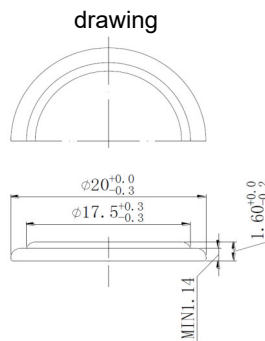

printed production date
 4 digits (YYMM)
 e.g. 1806 = 2018 June

nominal weight: 2.0 g (approx.)

	ANSMANN Specifications for model:	Lithium Button Cell CR2016
	data sheet no. / part no.	
	supplier no.	703700
	author / date	TG / 15.01.2019