

battery type: Lithium Button Cell
battery size: CR2330
chemical system: Lithium Manganese Dioxide

nominal voltage: 3.0 V
open circuit voltage: 3.0...3.4 V (new battery)
 2.9...3.4 V (after 1 year storage at 20°C)

Conditions

all measurements at 22 ± 2°C ambient

capacity rated: 250 mAh (continuous discharge at 15kΩ load; 24hours/day End Voltage (EV): 2.0V)

minimum: 230 mAh (continuous discharge at 15kΩ load; 24hours/day End Voltage (EV): 2.0V)

Standard discharge time minimum: 220 h (at 3kΩ load EV: 2.0V) (for QC measurement)

Discharge currents standard: 0.2 mA

max. recommended current under continuous discharge: 3 mA

max. recommended current under pulse discharge: 20 mA

Discharge diagrams:

Discharge Characteristics on Load

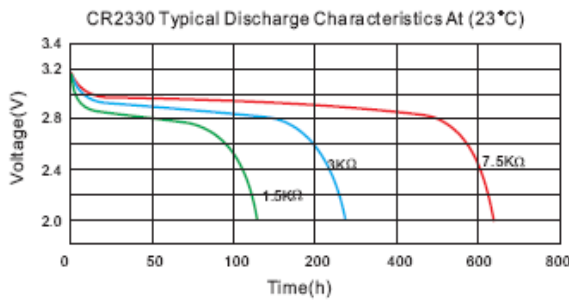

Discharge Characteristics on Temperature

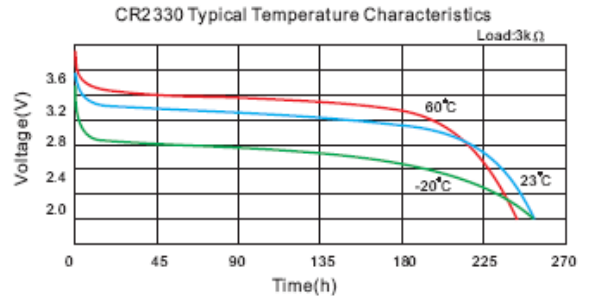

shelf life: 10 years under proper storage conditions (ta: ≤ 22°C; RH: 60 ± 15%)

operating temperature range: - 20...60 °C

mechanical specifications:

dimensions in mm

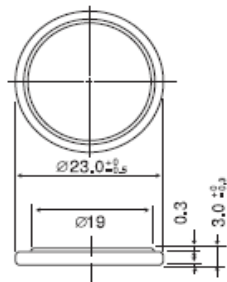

nominal weight: 4.0 g



blister card dimensions: 56 x 71.5mm

weight: 5.8g (incl. battery)

| | | |
|---|--|---|
|  | ANSMANN Specifications for model: | CR2330 Lithium Button Cell blister package |
| | data sheet no. / part no. | 1516-0009 |
| | supplier no. | 702572 |
| | author / date | TG / 20.03.2013 |