

40mm

40mm

5. After the device has been successfully added, click "DONE" for next step.

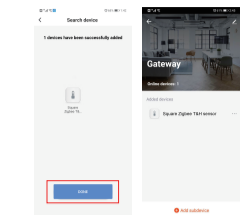

6. Click the device to enjoy its intelligent control for home automation.



Product Specifications

Product Name	Zigbee Temperature Humidity Sensor
Battery specification	CR2032 button cell
Wireless protocol	Zigbee
Temperature measurement range	-100~50°C
Humidity measurement range	0%~99%RH
Working voltage	DC2.4V~3V
Product size	ø50x16.7mm/16.7x60x60mm
Screen size	ø46.5mm/46.5x46.5mm
Product net weight	42g/49.5g

SERVICE

1. During the free warranty period, if the product breaks down during normal use, we will offer free maintenance for the product.
2. Natural disasters/man-made equipment failures, disassembly and repair without the permission of our company, no warranty card, products beyond the free warranty period, etc., are not within the scope of free warranty.
3. Any commitment (oral or written) made by the third party (including the dealer/service provider) to the user beyond the warranty scope shall be executed by the third party.
4. Please keep this warranty card to ensure your rights.
5. Our company may update or change the products without notice. Please refer to the official website for the updates.

RECYCLING INFORMATION

All products marked with the symbol for separate collection of waste electrical and electronic equipment (WEEE Directive 2012/19 / EU) must be disposed of separately from unsorted municipal waste. To protect your health and the environment, this equipment must be disposed of at designated collection points for electrical and electronic equipment designated by the government or local authorities. Correct disposal and recycling will help prevent potential negative consequences for the environment and human health. To find out where these collection points are and how they work, contact the installer or your local authority.



FCC Statement

Federal Communication Commission Interference Statement  
This equipment has been tested and found to comply with the limits for a Class B digital device, pursuant to Part 15 of the FCC Rules. These limits are designed to provide reasonable protection against harmful interference in a residential installation. This equipment generates, uses, and can radiate radio frequency energy and, if not installed and used in accordance with the instructions, may cause harmful interference to radio communications. However, there is no guarantee that interference will not occur in a particular installation. If this equipment does cause harmful interference to radio or television reception, which can be determined by turning the equipment off and on, the user is encouraged to try to correct the interference by one or more of the following measures:  
• Reorient or relocate the receiving antenna.  
• Increase the separation between the equipment and receiver.  
• Connect the equipment into an outlet on a circuit different from that to which the receiver is connected.  
• Consult the dealer or an experienced radio/TV technician for help.

FCC Caution:

This device complies with Part 15 of the FCC Rules. Operation is subject to the following two conditions: (1) This device may not cause harmful interference, and (2) this device must accept any interference received, including interference that may cause undesired operation.

Non-modification Statement:

Changes or modifications not expressly approved by the party responsible for compliance could void the user's authority to operate the equipment.

Radiation Exposure Statement

This equipment complies with FCC radiation exposure limits set forth for an uncontrolled environment. This equipment should be installed and operated with minimum distance 20cm between the radiator and your body.

WARRANTY CARD

Product information  
Product Name \_\_\_\_\_  
Product Type \_\_\_\_\_  
Purchase date \_\_\_\_\_  
Warranty Period \_\_\_\_\_  
Dealer information \_\_\_\_\_  
Customer's Name \_\_\_\_\_  
Customer Phone \_\_\_\_\_  
Customer Address \_\_\_\_\_

Maintenance Records

Failure date	Cause Of Issue	Fault Content	Principal

Thank you for your support and purchase at we Moes, we are always here for your complete satisfaction, just feel free to share your great shopping experience with us.

★★★★★  
If you have any other need, please do not hesitate to contact us first, we will try to meet your demand.

FOLLOW US



WENZHOU NOVA NEW ENERGY CO.,LTD  
Address: Power Science and Technology Innovation Center,  
NO.238, Wei 11 Road, Yangjia Economic Development Zone,  
Yangjia, Zhejiang, China  
Tel: +86-577-57198815  
Email: service@moeshouse.com

AMZLAB GmbH  
Laubenhof 23, 45326 Essen  
Made in China



Zigbee Temperature Humidity Sensor  
Instruction Manual



- Bitte scannen Sie den QR-Code, um das deutsche Handbuch, das Installationsvideo und die Funktionseinführung zu erhalten.
- Escanee el código QR para obtener el manual en español, el video de instalación y la introducción de la función.
- Veuillez scanner le code QR pour obtenir le manuel en français, la vidéo d'installation et l'introduction des fonctions.
- Отсканируйте QR-код, чтобы получить русский язык инструкции и обучающее видео по установке и введению в эксплуатацию.
- Leia o código QR para obter o manual em português, o vídeo de instalação e a introdução das funções.

请扫描二维码获取中文说明书、安装视频及功能介绍

Table Place Mode

Temperature Humidity Sensor on the table to use.

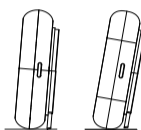

Hanging Mode

Temperature Humidity Sensor hanging on a nail.

Wall-mounting Mode

Peel of the wall sticker release paper and stick one side of the wall sticker to the adhesive area on the back of the product; after removing the other side of the release paper, stick the product on the indoor wall.

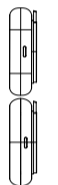

Maintenance and Care

● Battery Replacement  
Open the back cover from the bottom of the body, put a moes CR2032 positive button battery up into the battery compartment, and then squeeze it hard against the clasp and snap the back cover closed.

Maintenance

Avoid washing the product with water, and avoid scrubbing with acid and alkaline detergent.

Packing list

- Temperature Humidity Sensor x1
- Product manual x1
- Wall stickers x1

Product Introduction

Zigbee Temperature Humidity Sensor can sense the temperature of surrounding environment and humidity changes in real time, actively report to the user side at the same time, combined with other products to achieve a multifunctional smart home scenario.

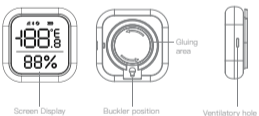
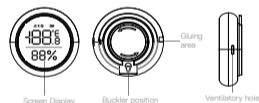

Preparation for use

1. Cell phone connected to Zigbee gateway



Ensure that the product is within the effective coverage area of the smartphone (or Zigbee gateway) network to ensure an effective connection between the product and the smartphone (or Zigbee gateway) network.

2. Download and open the APP

Search "Smart Life" in the app store or scan the QR code on the package/manual to download and install the APP. If you are downloading for the first time, please click the "Register" button to register your account. If you already have an account, click the "Login" button.



[Smart Life] APP

Zigbee Link/Reset:

1. Please pull out the insulator in the Zigbee Hygrometer for normal power on state.
2. Click the ZigBee gateway for device adding.  
Note: Make sure you have successfully connected one Zigbee gateway hub.
3. Confirm the device is in pairing mode (Long press the reset button on the back until the ZigBee icon flashes).



4. Click "Add subdevice" and the "LED already blink" for device searching

