

LED PANEL INSTALLATION MANUAL

asaLITE[®]



ATTENTION / NOTICE

Turn off the power before performing a check, installation, or removal.
Make proper electrical grounding.

Suspending mount

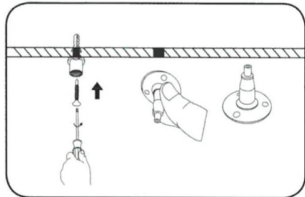

① Screw the round bases on the ceiling.

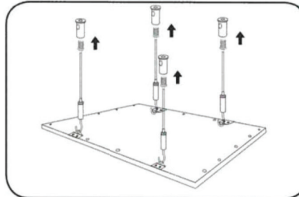

② Fasten the hooks on the handle of the clip.

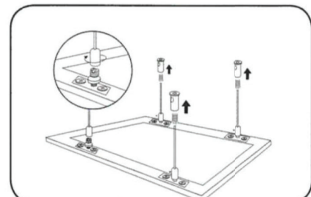

③ Screw the two screws faces in the frame. Tighten the nut to the side.

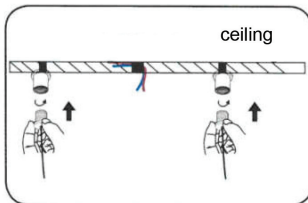

④ Screw the cable to the ceiling mount.

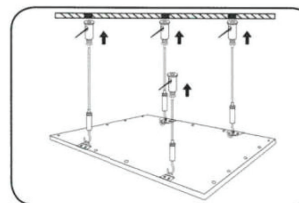

⑤ Attach the LED panel to the ceiling, and make final adjustments to the desired height.

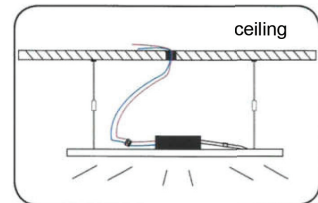

⑥ Connect the driver to the electrical network.

Built-in (supported on T-bar)

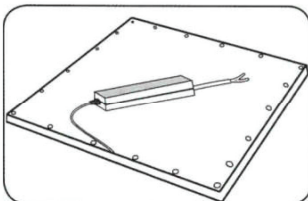

① Connect the driver to the LED and lean it on the back.

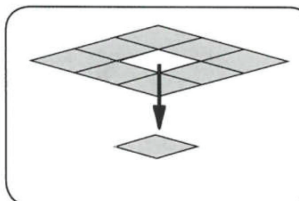

② Remove the ceiling plate from the plaster.

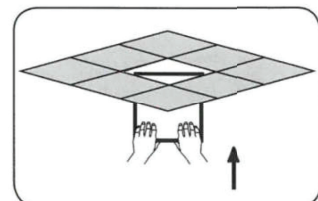

③ Place the LED panel on the ceiling grid.

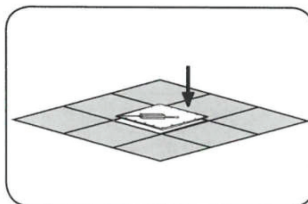

④ Make sure the LED panel is set properly inside the T bars of the ceiling.

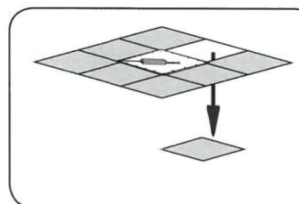

⑤ Remove a ceiling plate from the close to the LED panel.

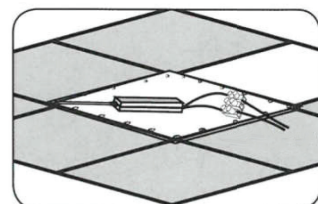

⑥ Make the electrical connection driver to the power network.

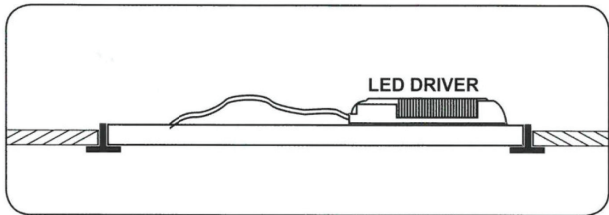
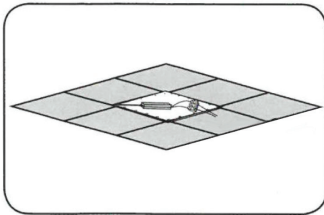

- ⑦ Replace the plasterboard to complete the installation.

Built-in lining (spring clip)

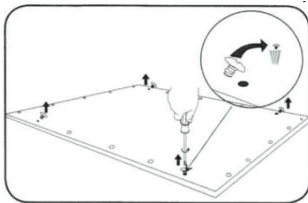

- ① Remove the screws from the position indicated in the picture.

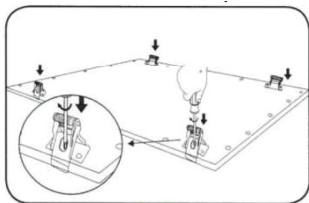

- ② Fasten the tabs to the same positions as the removed screws by screwing in the center.

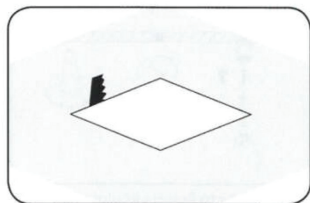

- ③ Make a cut in the ceiling of according to the measures to be built.

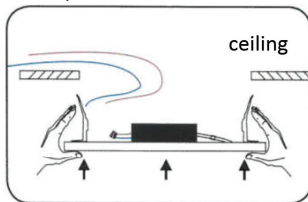

- ④ Wire the driver. With the tabs open, place the panel inside the ceiling.

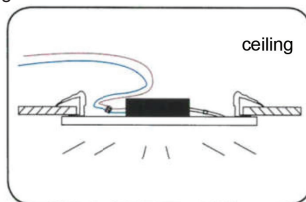

- ⑤ Grip loops gently until the panel fixes on the ceiling, completing the installation.

Supported overlay

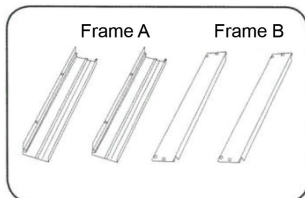

- ① Identify the two types of frame as shown above.

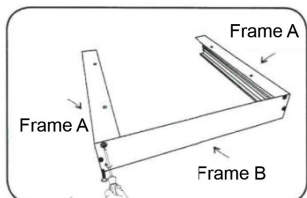

- ② Screw two frames "A" with ----- a frame "B".

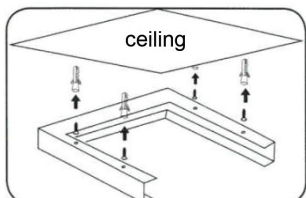

- ③ Screw the frame into the ceiling

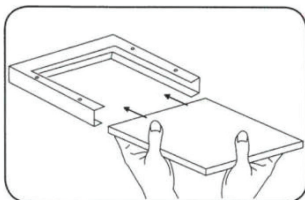

- ④ Attach the LED panel to the frame by sliding it.

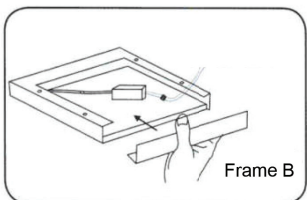

- ⑤ Screw the other frame "B" on the remaining side.

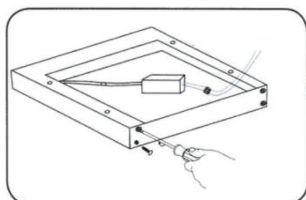

- ⑥ Finish the electrical installation and screw the frame.

Importer / Forgalmazó / Importeur / Importateur / Dovožca / Dovožce / Importator / Uvoznik / Uvoznik :

Peter Monoki E.V., 4033 Debrecen Vak Bottyán street 22/A Hungary E-mail: info@asalite.com If you have any enquires or need a product support, please contact your local distributor. For more information, visit: www.asalite.com Made in / Gyártási hely / Produis in / Ursprungland / Fabriqué en / Vyrobeno v / Vyrobené v / Zemlja porijekla / Izdelano v : P.R.C. Copyright © 2019. Asalite All rights reserved.